



26 Moorhead Avenue MORNINGTON VIC

4 2 2

Well-maintained and ready for first-time homeowners, savvy investors, or young families seeking an opportunity to add their own flair, this dual-living zone home boasts a private and relaxed setting only moments from Bentons Square Shopping Centre and Benton Junior College.

Warm tones and open dimensions embrace a light-filled layout, as a front formal lounge gently stretches into a generous social domain framed by rear garden views. A laminate kitchen conceals a Westinghouse wall oven, dishwasher, microwave cavity and breakfast bar, before combination floors define casual living and dining space. Expanding beyond, a large covered patio with pitched roofline beckons lazy summer afternoons watching the kids play safely within a low-maintenance yard with side dog

Type : House
Price : \$ 920,000
Land Size : 680 sqm
View : <https://www.mcewingpartners.com/sale/vic/mornington-peninsula/mornington/residential/house/8318128>

[For full version visit the website](#)



Lisa Bendle
0359754555



Dean Phillips
0359754555

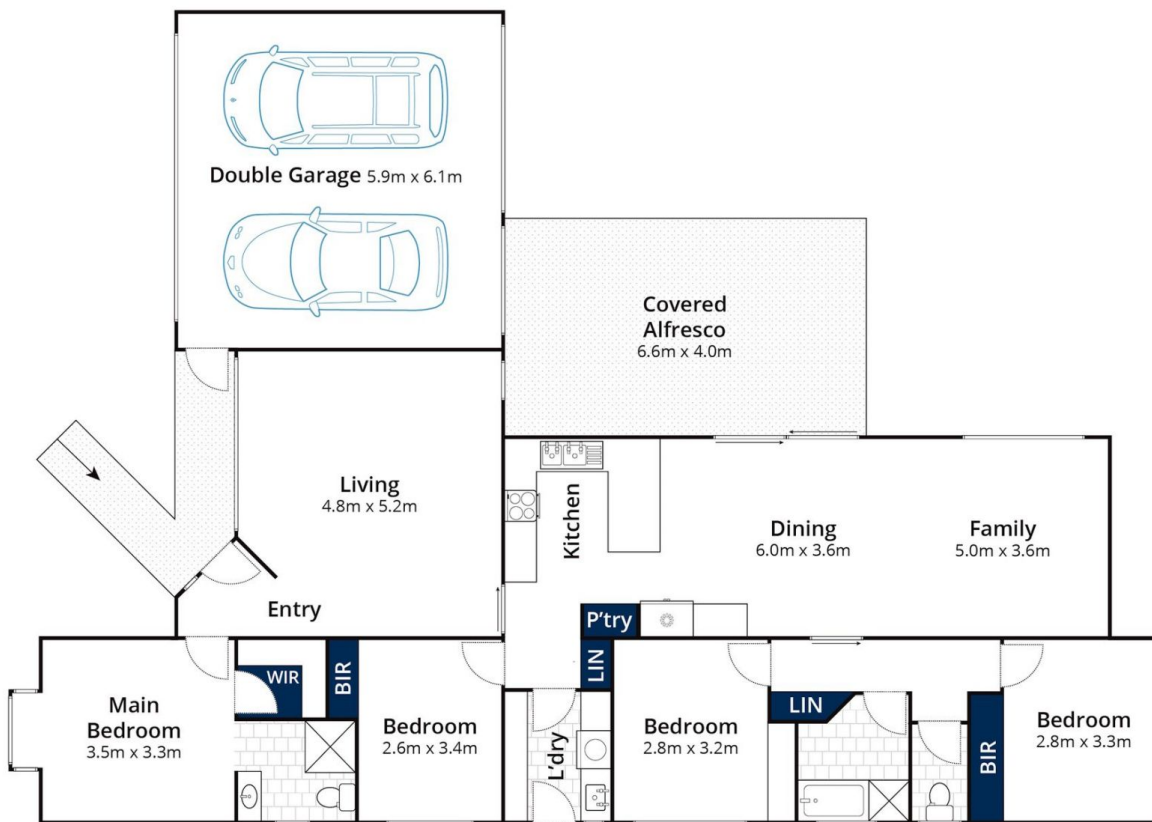

Ground Floor

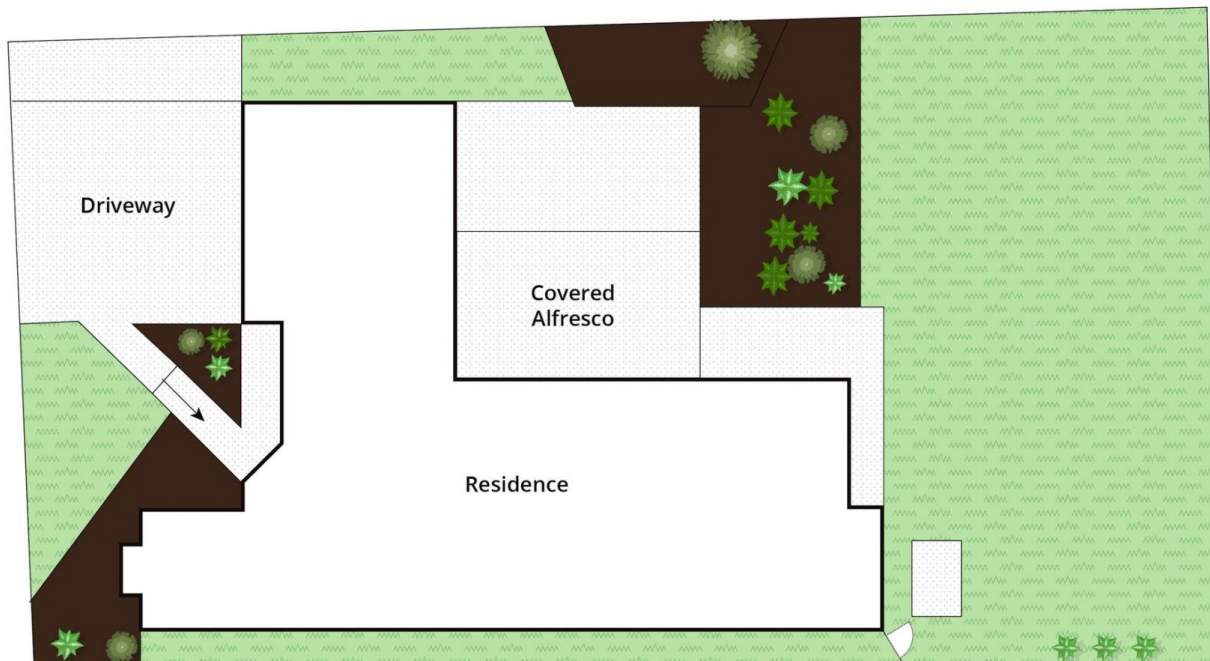

Site Plan

Approx House Area 180m²

Approx Land Area 680m²

Whilst bwr.com.au has made every attempt to ensure the accuracy of the floor plan contained here, measurements are approximate and no responsibility is taken for any error, omission, or mis-statement. This plan is for illustrative purposes only.

26 Moorhead Avenue, Mornington