



## 1 Hume Street MOUNT MARTHA VIC

4 4 2

Panoramic Bay vistas to the city skyline are on breathtaking show from multiple aspects of this outstanding, elevated Mount Martha residence, perfect for grand-scale resort-style living and entertaining in light-filled northerly facing splendour.

Gracing a large corner allotment measuring 1064 square metres (approx.), the impressive two-storey residence has recently undergone some stylish enhancements. Fresh new paintwork, plantation shutters and a Hampton's style auto timber garage door adding to the contemporary coastal street appeal. Upon entry, the home's breathtaking dimensions are immediately apparent with soaring ceilings, a sweeping staircase, and engineered timber flooring throughout the ground-level formal and informal living

**Type** : House  
**Price** : \$2,200,000 - \$2,400,000  
**Land Size** : 1064 sqm  
**View** : <https://www.mcewingpartners.com/sale/vic/mornington-peninsula/mount-martha/residential/house/8309545>

[For full version visit the website](https://www.mcewingpartners.com)



**Dean Phillips**  
0359754555



**Grace Green**  
0359754555

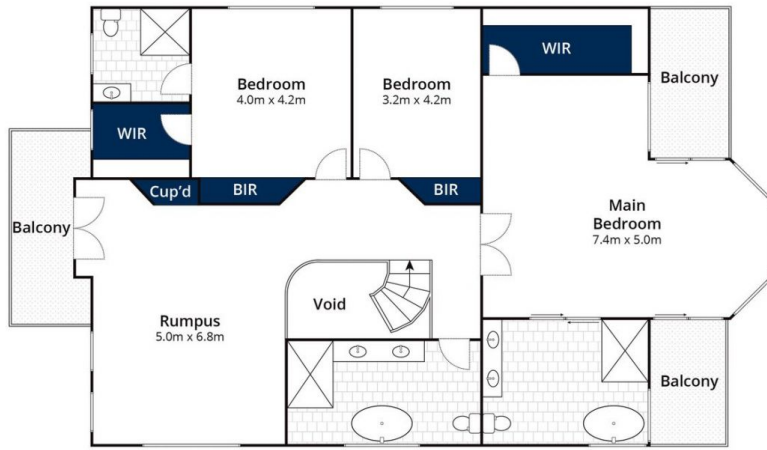

First Floor

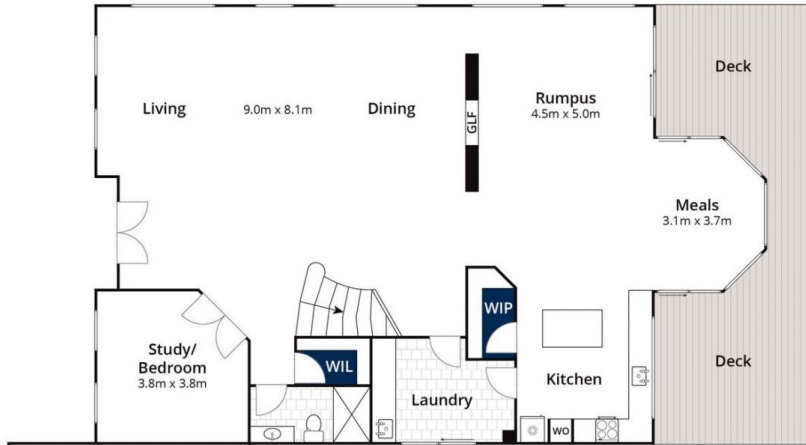

Ground Floor

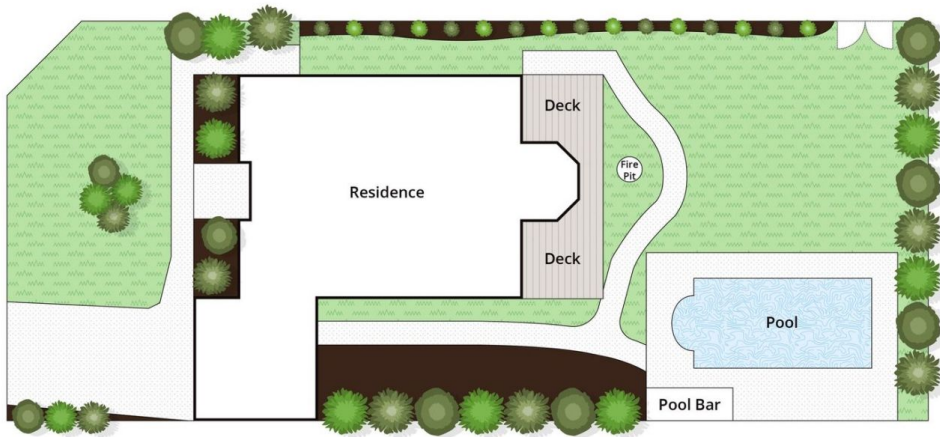
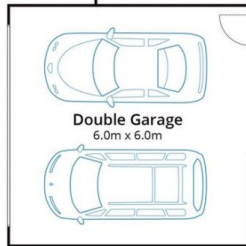

Site Plan

Approx House Area 368m<sup>2</sup>  
Approx Land Area 1064m<sup>2</sup>

Whilst [bwr.com.au](http://bwr.com.au) has made every attempt to ensure the accuracy of the floor plan contained here, measurements are approximate and no responsibility is taken for any error, omission, or mis-statement. This plan is for illustrative purposes only.

# 1 Hume Street, Mount Martha