

8 Caraar Creek Lane MORNINGTON VIC

3 1 2

Residing on an esteemed stretch of Mornington's premier cliff-top, 'Lynmouth' stands as a truly exceptional and unparalleled landholding of approximately 1,030sqm, offering breathtaking panoramic Port Phillip Bay views. Originally acquired during the Tallis subdivision and held securely over the years, this extraordinary chance has now emerged, offering a rare opportunity for discerning buyers to own a prestigious cliff-top Mornington address.

Embodying the timeless elegance of early coastal architectural style where views remain a priority, the original weatherboard home includes a living room, sunroom, kitchen with internal servery, main bathroom and three bedrooms, a north-facing verandah, and car accommodations.

[For full version visit the website](https://www.mcewingpartners.com/sale/vic/mornington-peninsula/mornington/residential/house/8089892)

Type : House
Land Size : 1030 sqm
View : <https://www.mcewingpartners.com/sale/vic/mornington-peninsula/mornington/residential/house/8089892>



Quentin McEwing
0397872422



Dean Phillips
0359754555

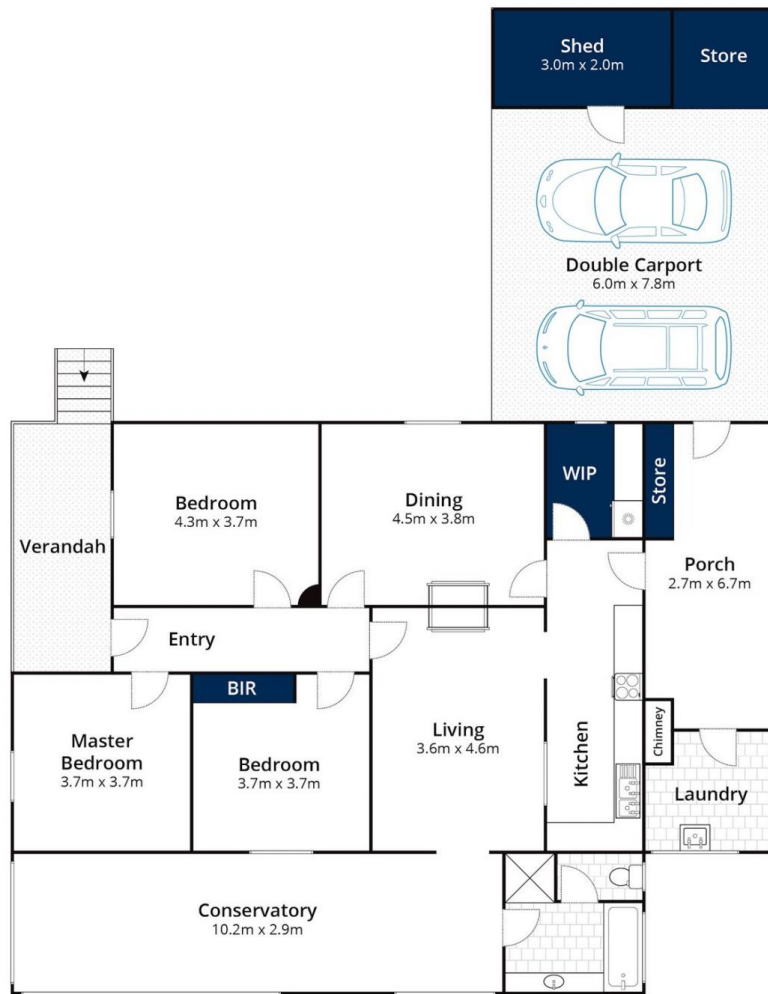

Ground Floor

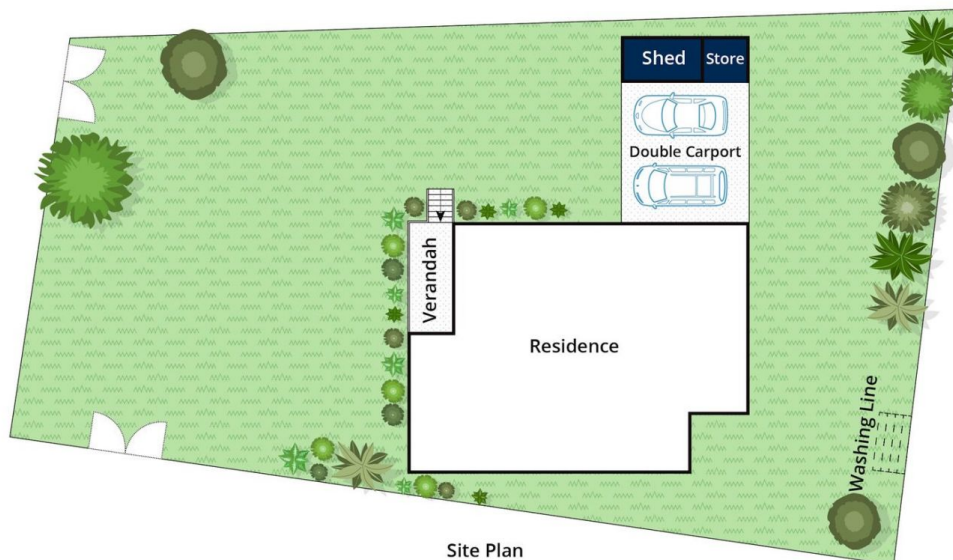

Site Plan

Approx House Area 173m²
Approx Land Area 1030m²

Whilst bwr.com.au has made every attempt to ensure the accuracy of the floor plan contained here, measurements are approximate and no responsibility is taken for any error, omission, or mis-statement. This plan is for illustrative purposes only.

8 Caraar Creek Lane, Mornington