



18 Rosserdale Crescent MOUNT ELIZA VIC

3 1 2

A highly coveted beachside locale for those seeking the ultimate coastal lifestyle, this modest three-bedroom home welcomes an effortless blend of comfort and modern amenity. Situated just a stone's throw from the prestigious Ranelagh Club and the shallows of Earimil Beach North, the 803sqm (approx.) block offers very broad opportunistic appeal for those wanting location with multiple options for now or the future.

Flaunting exceptional bones for contemporary refurbishment, the brick home captures bay glimpses from a front lounge while family dynamics spill to a living, meals and kitchen comprising electric cooktop, Whirlpool oven and dishwasher. Catering to comfort with an updated bathroom, the three-bedroom layout currently offers the unique opportunity for entry level living in a prized location or convenient place to reside while awaiting the approval of plans and permits. (STCA).

Price : \$1,650,000 - \$1,750,000
Land Size : 803 sqm
View : <https://www.mcewingpartners.com/sale/vic/bayside/mount-eliza/residential/house/7990553>



Quentin McEwing
0397872422



Kelsi Culhane
0397872422

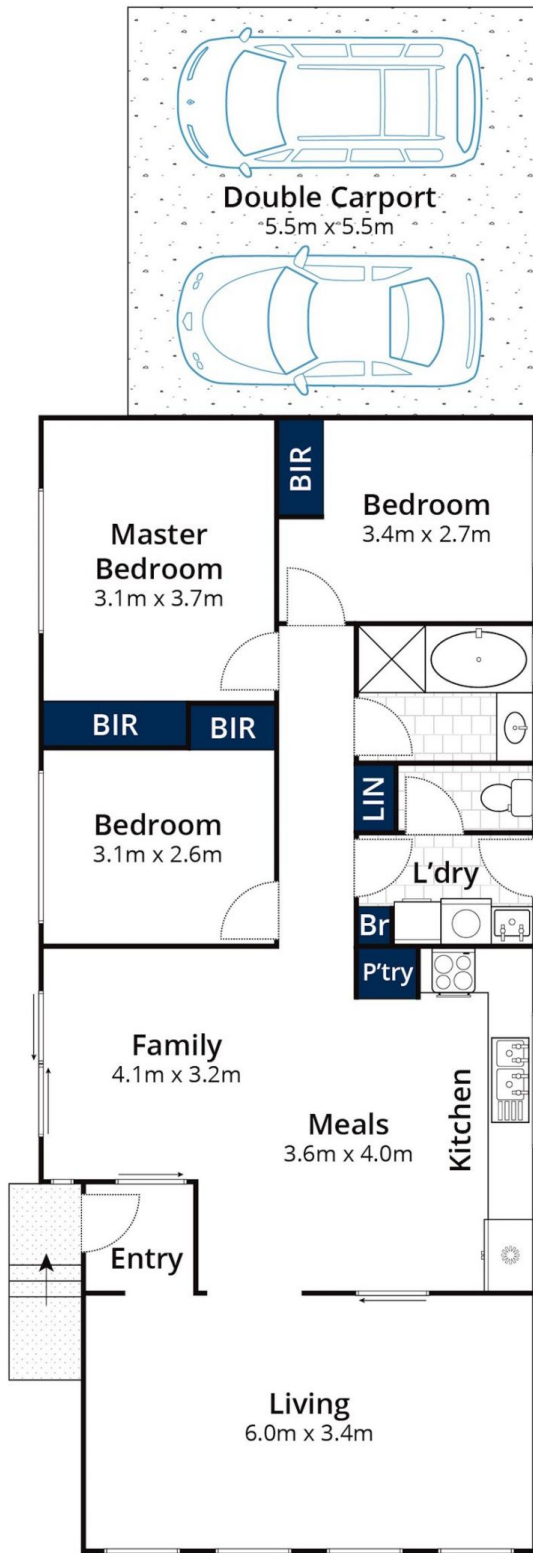

Ground Floor

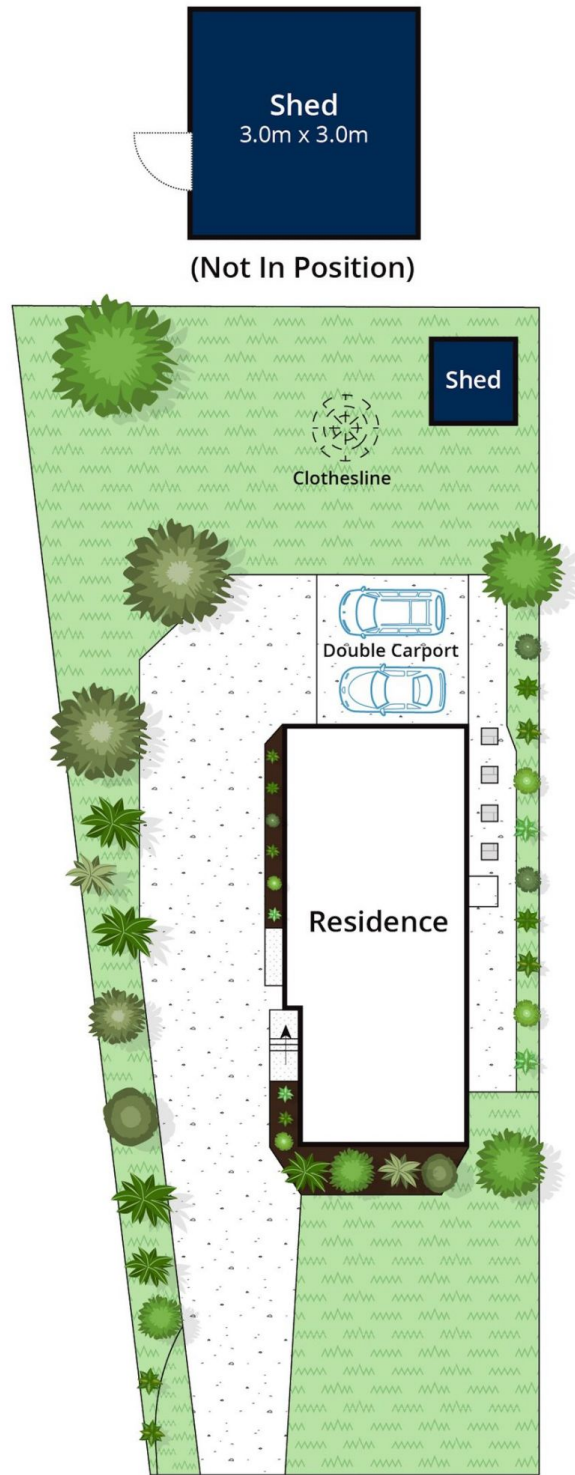

Site Plan

Approx House Area 98m²
Approx Land Area 798m²

Whilst bwr.com.au has made every attempt to ensure the accuracy of the floor plan contained here, measurements are approximate and no responsibility is taken for any error, omission, or mis-statement. This plan is for illustrative purposes only.

18 Rosserdale Crescent, Mount Eliza