



30 Shann's Avenue MOUNT MARTHA VIC

4 2 2

Capturing the very essence of relaxed coastal living, this private family home of light-filled proportions presents only steps from the shallows of Birdrock Beach and a short stroll from Mount Martha Village. An off-street introduction elevates the privacy of this single-level family home, designed with a seamless flow and a variety of versatile living zones suited to life's every chapter.

Discover a seamless fusion of sitting areas, casual dining space and choice in formal or informal living zones, as airy proportions and grand space centres a true entertainer's kitchen, where culinary delights and unforgettable moments are effortlessly crafted. A line-up of premium appliances including a gas cooktop, under-bench oven and dishwasher effortlessly enhances the hosting experience. The warmth of the afternoon sun beckons summertime entertaining outside, to a paved terrace surrounded by meticulously

Price : \$1,600,000 - \$1,750,000

View : <https://www.mcewingpartners.com/sale/vic/mornington-peninsula/mount-martha/residential/house/7978618>



Lisa Bendle
0359754555



Dean Phillips
0359754555

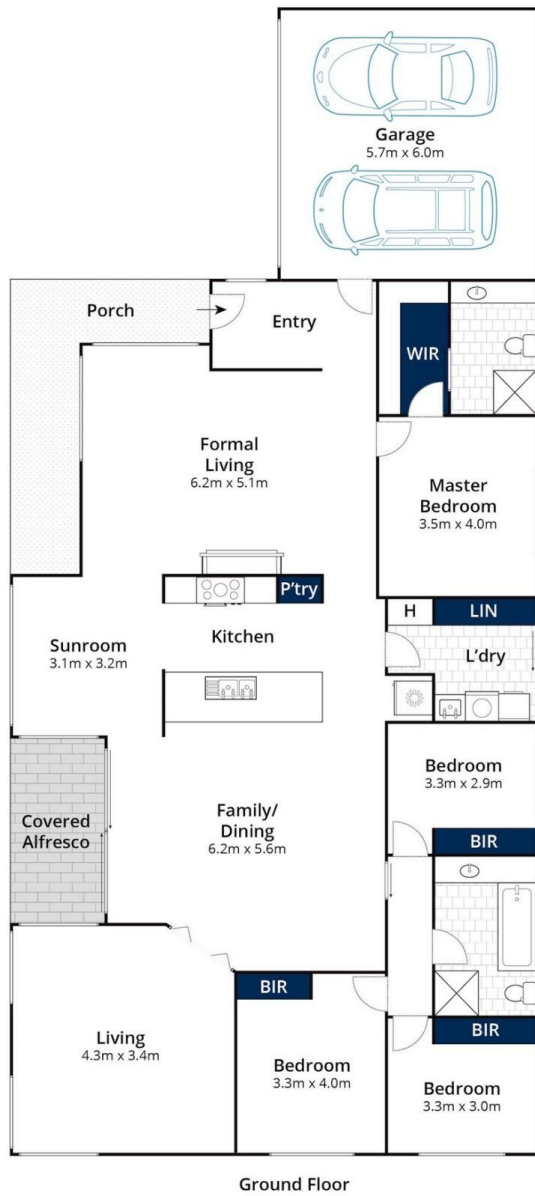

Approx House Area 241m²

Approx Land Area 1163m²

Whilst bwr.com.au has made every attempt to ensure the accuracy of the floor plan contained here, measurements are approximate and no responsibility is taken for any error, omission, or mis-statement. This plan is for illustrative purposes only.

30 Shanns Avenue, Mount Martha