

14/1a Annette Court HASTINGS VIC

3 2 2

An address within one of Hasting's most prized gated-communities, this beautifully spacious dual-storey home champions its modern interiors and morning sunshine with heightened ceilings, stone finishes and a rear north-facing aspect.

Featuring ground-floor entertaining with generous low-maintenance gardens, the home's thoughtful accommodation layout ensures versatility spans the ages, making it perfect for the retiree or first-time purchaser. Welcoming throughout with heightened ceilings and ample natural light, a set-back living and dining zone spills around a stone-finished kitchen, where all-Technika appliances include an underbench oven, dishwasher and gas cooktop.

Introduced by the ground-floor master suite with ensuite and walk-in robe, two junior bedrooms each with built-in

Price : \$640,000 - \$710,000

View : <https://www.mcewingpartners.com/sale/vic/mornington-peninsula/hastings/residential/house/7922488>



Lisa Bendle
0359754555



Indi Fisher
0359754555

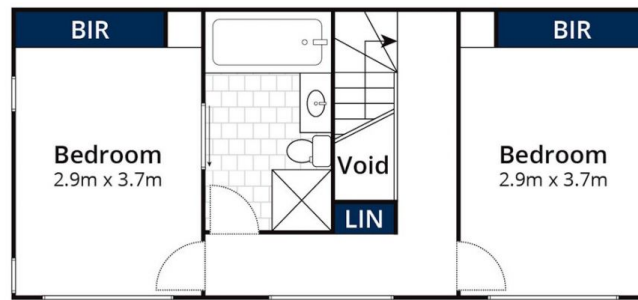

First Floor

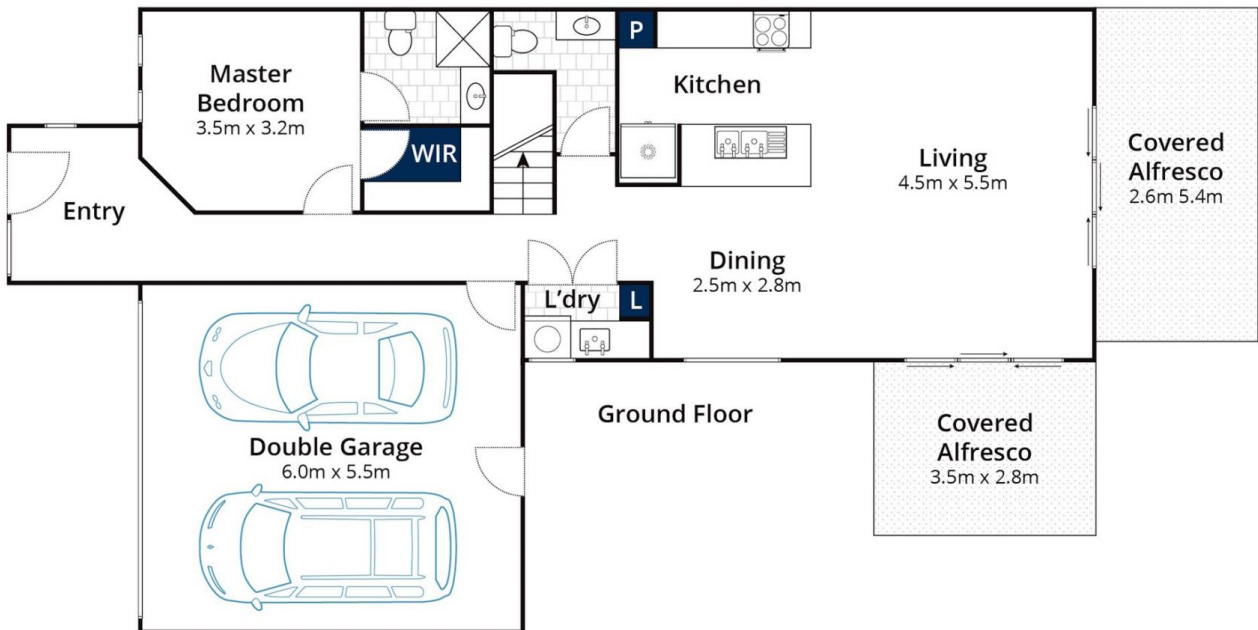

Ground Floor

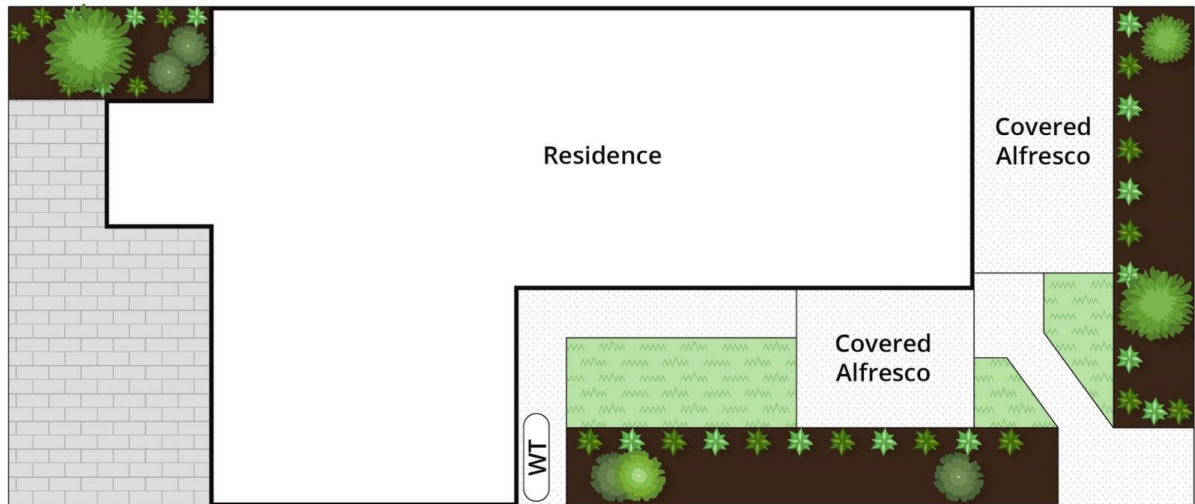

Site Plan

Approx House Area 162m²
Approx Land Area 212m²

Whilst bwr.com.au has made every attempt to ensure the accuracy of the floor plan contained here, measurements are approximate and no responsibility is taken for any error, omission, or mis-statement. This plan is for illustrative purposes only.

14/1A Annette Court, Hastings