



16/76 Harrap Road MOUNT MARTHA VIC

3 **2** **2**

Packaged within the immaculate garden setting of "Delgany", on a premium rear corner block, an unfolding of low-maintenance living presents across a light-filled dual-storey design as a privileged downsizer lifestyle presents only a moment's walk from Bentons Square Shopping Centre and Dunns Road Reserve.

Drenched in a north-east light, the 3-bedroom layout presents a sensational unity of space and functionality as an open plan living and dining zone centres a stone-finished kitchen with Technika gas cooktop and oven, and generous cabinetry. Perimeter planting softens a collection of practical interior surfaces, as ample glazing opens to reveal a generous covered patio and private potter-perfect gardens.

Met with a functional footprint for young families, first-time

Price : \$ 815,000

View : <https://www.mcewingpartners.com/sale/vic/mornington-peninsula/mount-martha/residential/townhouse/7916718>



Lisa Bendle
0359754555



Alexandra Otte
0359754555

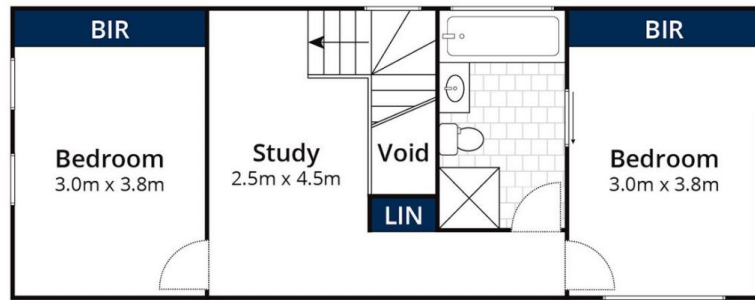

First Floor

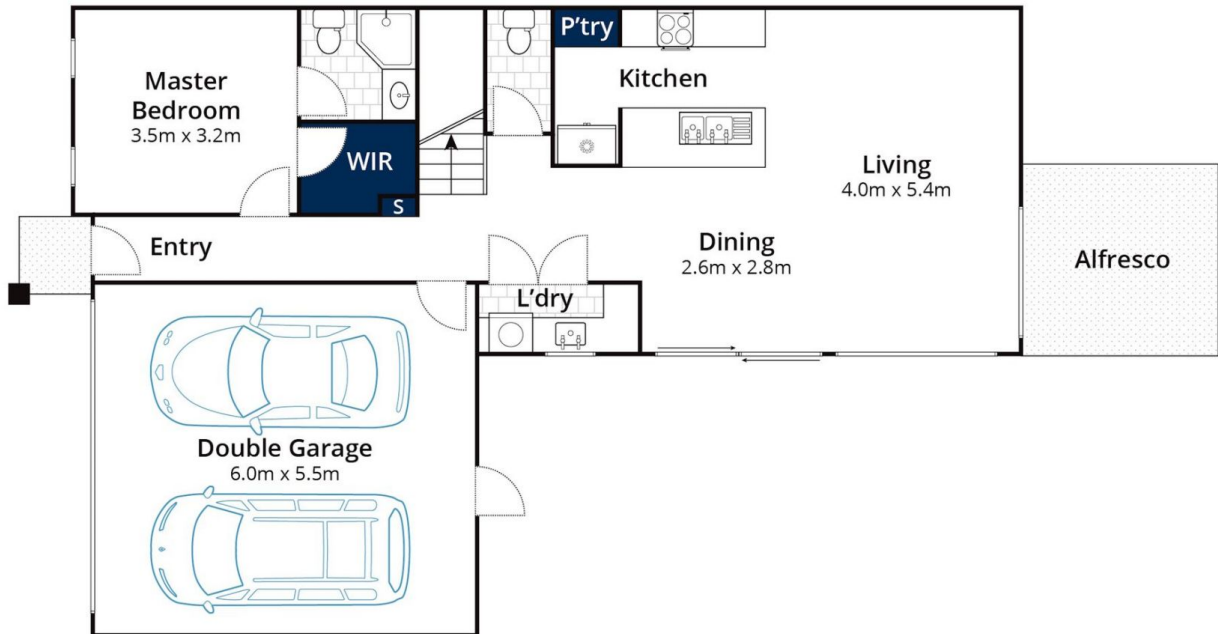

Ground Floor

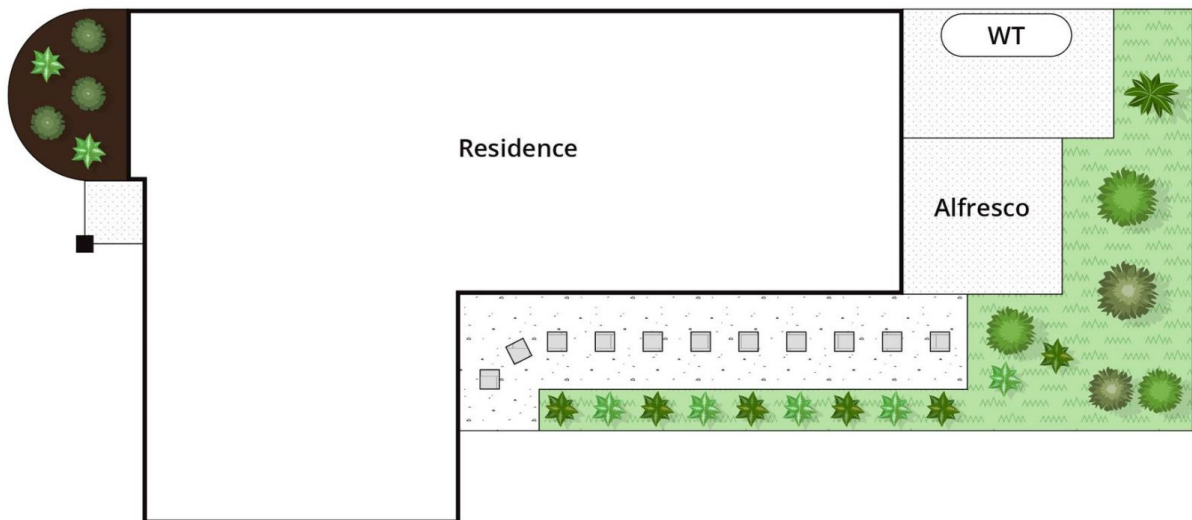

Site Plan

Approx House Area 162m²
Approx Land Area 175m²

Whilst bwr.com.au has made every attempt to ensure the accuracy of the floor plan contained here, measurements are approximate and no responsibility is taken for any error, omission, or mis-statement. This plan is for illustrative purposes only.

16/76 Harrap Road, Mornington