

50A Glen Shian Lane MOUNT ELIZA VIC

3 2 2

Crowning the apex of an elevated allotment to harness sweeping views across the bay, this brand new coastal home parades a peerless beachside lifestyle in an exclusive enclave Mount Eliza. Designed and constructed to impeccable standards by award-winning Latitude 37, luxury unfolds across two sundrenched levels revealing three living zones and expansive water vistas from both floors. A culinary kitchen is a chef's delight with a stone-topped breakfast island, walk-in pantry and brand new premium appliances, while banks of sliding glass on both levels open to a choice of alfresco terraces, each providing a sublime backdrop for the spectacular sunsets over Port Phillip Bay. An easy walk to Toorak College, Canadian Bay Beach and the cafes and restaurants of the village, this showstopping property delivers the quintessential Golden Mile package for the fortunate few.

Price : \$2,850,000 - \$3,000,000

View : <https://www.mcewingpartners.com/sale/vic/bayside/mount-eliza/residential/house/7785682>



Quentin McEwing
0397872422



Kelsi Culhane
0397872422

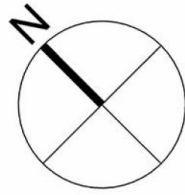

Internal area = 27 squares (approx)
 External living area = 7 squares (approx)
 Garage area = 4 squares (approx)

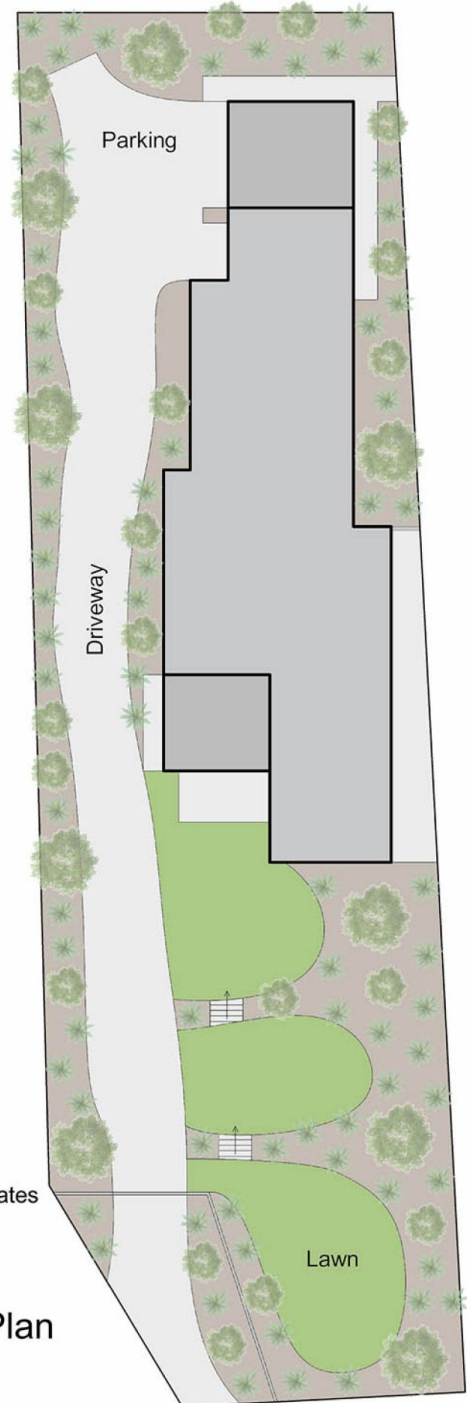

50a Glen Shian Lane, Mount Eliza

This floorplan is for illustration purposes only and no warranty is given to its accuracy. Purchasers are advised to carry out their own investigations. Produced by **realitywriters** (03) 5970 2222