



## 31 Rendlesham Avenue MOUNT ELIZA VIC

2 1 1

A breathtaking trio of sunsets, sand and sea delivers an impressive backdrop to secluded cliff top living as this two-bedroom log cabin champions spectacular Port Phillip Bay aspects at every turn.

Sealed from the street with a private frontage, a manicured landscape of approximately 932sqm opens to direct beach access making this an ideal lifestyle for downsizers or an exceptional foundation for development.

Cherished original character preserves a compact footprint introduced by cosy living and dining dimensions and a practical kitchen design. An open fireplace and split-system heating and cooling ensure an easy adjustment to the seasons, while timber log interiors and a vaulted ceiling

**Type** : House

**View** : <https://www.mcewingpartners.com/sale/vic/bayside/mount-eliza/residential/house/7694950>



**Quentin McEwing**  
0397872422



**Kelsi Culhane**  
0397872422

[For full version visit the website](https://www.mcewingpartners.com)



(Not In Position)

Ground Floor

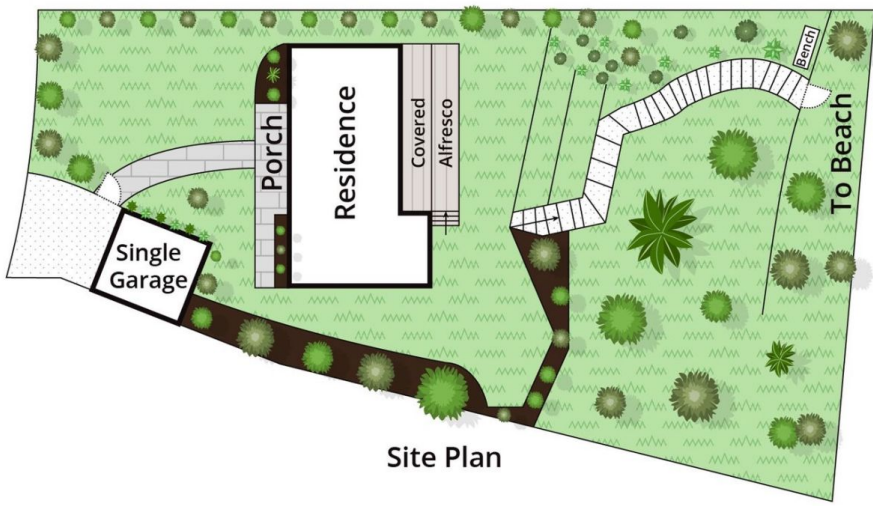

Site Plan

Approx House Area 88m<sup>2</sup>  
Approx Land Area 933m<sup>2</sup>  
Whilst [bwr.com.au](http://bwr.com.au) has made every attempt to ensure the accuracy of the floor plan contained here, measurements are approximate and no responsibility is taken for any error, omission, or mis-statement. This plan is for illustrative purposes only.

# 31 Rendlesham Avenue, Mount Eliza