



28 Beleura Hill Road MORNINGTON VIC

4  2  2 

Capturing a brilliant panorama over Mornington Harbour and Mothers Beach from coveted Beleura Hill, this sprawling four-bedroom residence presents a life of coastal opulence in a location that guarantees never to be built out. Cleverly designed to make the most of the sparkling vistas, from the show-stopping central living area and BBQ deck to the deluxe rumpus room with hotel-style bar, this lavish home also boasts a gourmet kitchen with stainless-steel appliances, spa ensuite, open fireplace and established gardens. Regular Garden Maintenance included.

- Luxurious living, only 650m to beach
- Panoramic views of Port Phillip Bay
- Stroll to the popular Main Street cafes and boutiques
- Central living area with sweeping bay vistas
- Deluxe rumpus room with full wet-bar
- Gourmet kitchen with stone counters

Land Size : 830 sqm
View : <https://www.mcewingpartners.com/lease/vic/mornington-peninsula/mornington/residential/house/7686932>



Melissa Sarmiento
0397872422

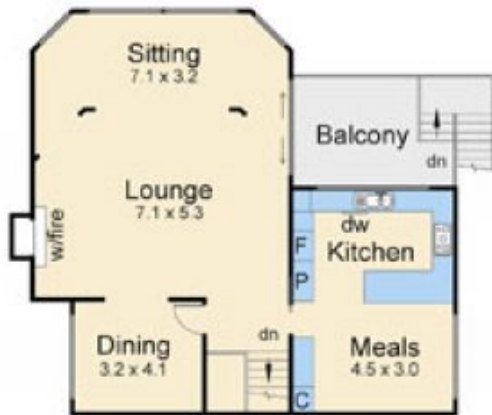
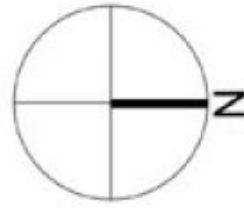

Upper Floor



Lower Floor



Site Plan

28 Beleura Hill Road, Mornington

This floorplan is for illustration purposes only and no warranty is given to its accuracy.
Purchasers are advised to carry out their own investigations
Produced by **realitywriters (03) 5970 2222**