



## 3/776-779 Esplanade MORNINGTON VIC

3 2 2

A paradise for lifestyle lovers in the beating heart of Mornington only steps to cafes and bistros and with the beach directly opposite, this sundrenched two-storey townhouse delights and surprises with fully modernised spaces, soaring architectural lines and expansive views across Port Phillip Bay. So close to the shore you can smell the salty zephyrs, the residence opens to a radiant north-facing living area with high ceiling, plush carpeting and a vast picture window framing Mornington Park and the bay beyond, while the modern kitchen boasts stainless-steel appliances and French doors off the dining zone opening to a private sun terrace. Upstairs, the light-filled master bedroom with Juliette balcony, walk-in robe and elegant ensuite is flanked by tall windows providing an almost bird's-eye view over the cobalt bay

**Type** : Apartment  
**Land Size** : 177 sqm  
**View** : <https://www.mcewingpartners.com/lease/vic/mornington-peninsula/mornington/residential/apartment/7595474>



**Samantha Stephenson**  
0397872422

[For full version visit the website](https://www.mcewingpartners.com)

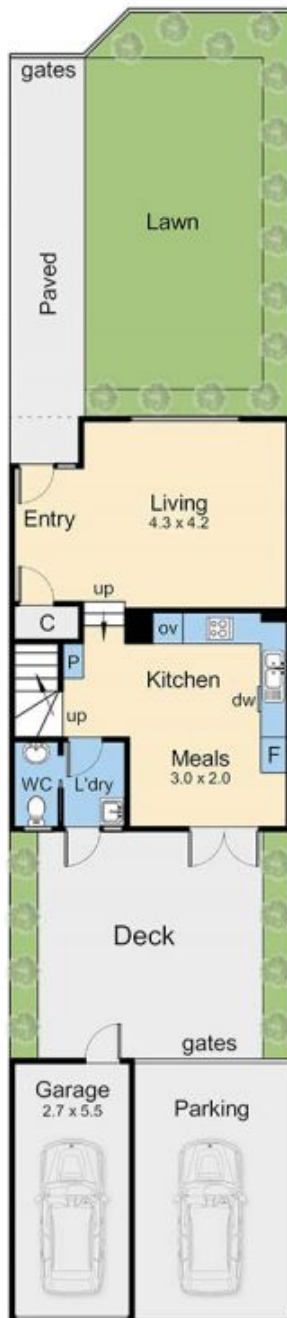

Lower Floor

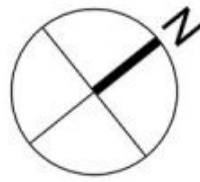

Internal area = 10.2 Squares

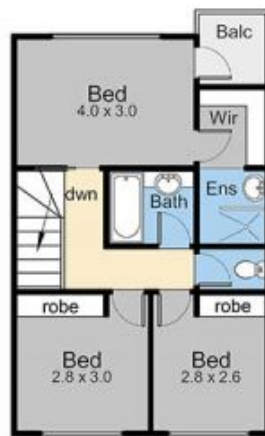

Upper Floor

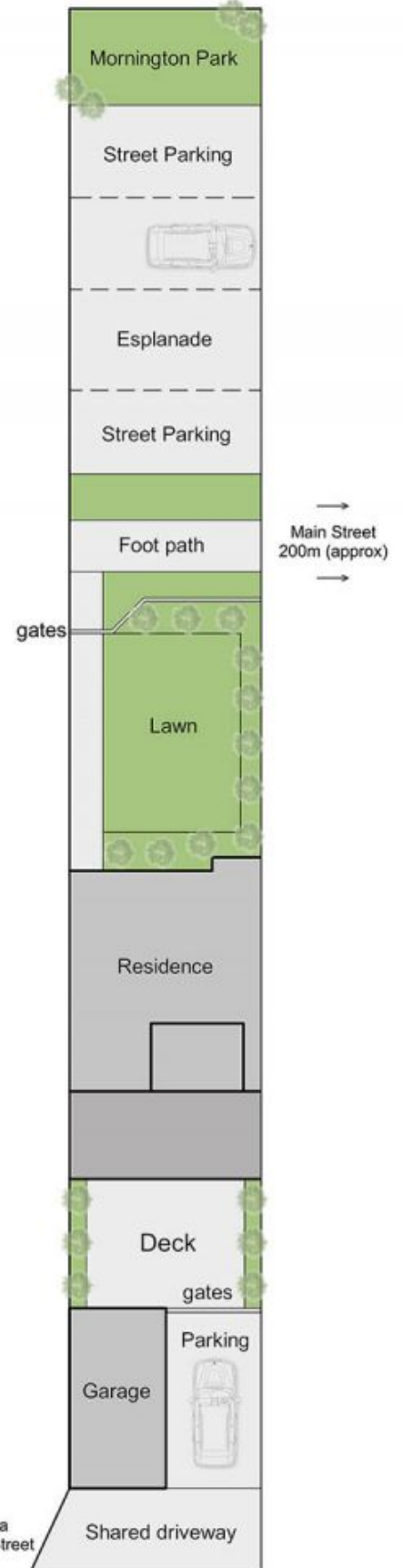

Site Plan

## 3/776-779 Esplanade, Mornington

This floorplan is for illustration purposes only and no warranty is given to its accuracy. Purchasers are advised to carry out their own investigations. Produced by **realitywriters** (03) 5970 2222