



49 Ellerina Road MOUNT MARTHA VIC

3  2  2 

Views over Port Phillip Bay, the southern Peninsula coastline and the hinterland, this hillside beach house offers picture-postcard living. This glass-fronted, split-level hideaway rests on the high side of the street. Watch the sun set over the water from a decadent full-width entertaining deck, and enjoy a private setting minutes to the beach, the harbour, golf courses and Peninsula Link. Unseen from the road, this 3 bedroom (4th of home office) residence offers a blend of seclusion and coastal accessibility, in relaxed style. Functional kitchen, the sky windows, the tranquility, and the ever-changing view.
REGISTER TO INSPECT

To inspect the property please click on the 'Inspections', Request a Time' button and enter your full details, you will then be sent a link to register for one of the available inspection times. If there is not one currently available, you will be notified when an inspection time becomes available.

Land Size : 2049 sqm

View : <https://www.mcewingpartners.com/lease/vic/mornington-peninsula/mount-martha/residential/house/7562845>



Samantha Stephenson
0397872422

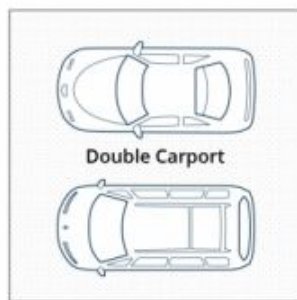
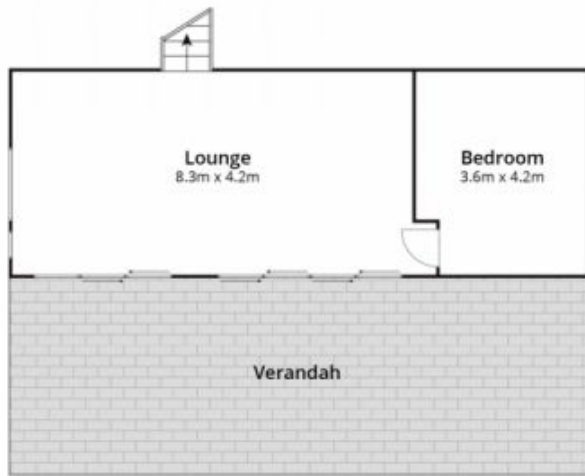

(Not In Position)

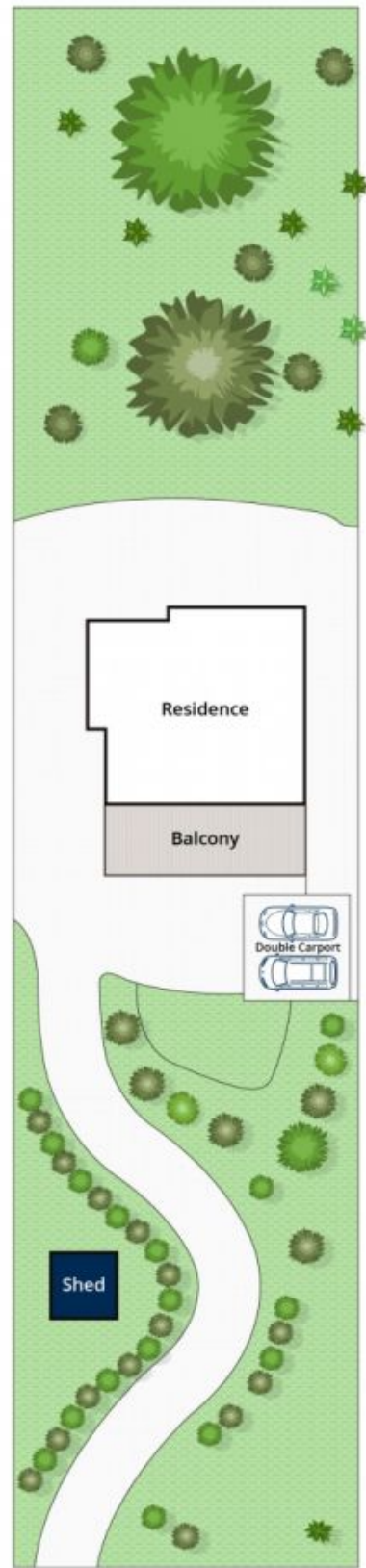

Approx House Area 182m²
 Approx Land Area 2049m²

Whilst bwr.com.au has made every attempt to ensure the accuracy of the floor plan contained here, measurements are approximate and no responsibility is taken for any error, omission, or mis-statement. This plan is for illustrative purposes only.

49 Ellerina Road, Mount Martha