



7 Volitans Avenue MOUNT ELIZA VIC

3 2 2

One of the last remaining large corner lots with a unique upside. Sculpted over a sundrenched multi-level design to harness sweeping views across the bay, this stunning coastal haven captures all the ambience of a grand modern Queenslander in highly-sought beachside Mt Eliza. Updated in sympathetic accord with the original character of the 1950s architectural design, the residence celebrates seaside living with an array of decks and balconies to soak up the balmy bay cross-breezes. At the pinnacle of the tri-storey layout, a heavenly lounge with gas log fireplace and spacious dining area are flanked by vast walls of glass opening to the outdoor entertaining area jutting out over the landscape to maximise the glistening blue vista. An epicurean kitchen with stone benchtops is well-appointed with premium appliances and a walk-in pantry, while a second living area within the junior/guest wing is fitted with library shelving and glass doors to the lower deck and

Land Size : 1434 sqm
View : <https://www.mcewingpartners.com/sale/vic/bayside/mount-eliza/residential/house/7509638>



Quentin McEwing
0397872422



Kelsi Culhane
0397872422

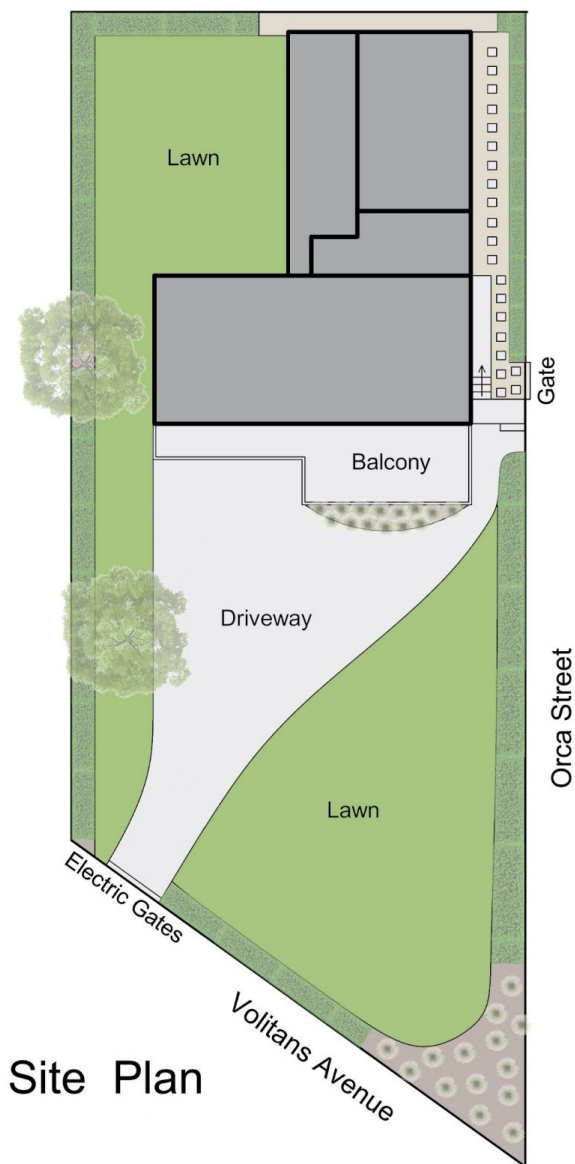

Internal living area = 20.7 squares
 External living area = 9.2 squares
 Garage area = 4.9 squares

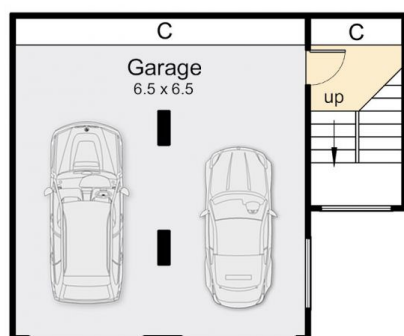

7 Volitans Avenue, Mount Eliza

This floorplan is for illustration purposes only and no warranty is given to its accuracy. Purchasers are advised to carry out their own investigations. Produced by **realitywriters** (03) 5970 2222