



38 Wimbledon Avenue MOUNT ELIZA VIC

3 2 2

Experience luxurious coastal living in this stunning architect-designed residence located in the highly coveted Ranelagh Estate. Built by the award-winning Master Builders, this contemporary Australian beachside home is perfect for those who want to live in style and comfort.

Located just a short stroll away from Mount Eliza Village and the picturesque Ranelagh beach, this stunning property offers the ultimate in coastal living. The property boasts striking living spaces, maximizing natural light and a seamless indoor-outdoor connection. The north-facing orientation captures sea breezes.

The immaculately presented private garden has been thoughtfully designed to showcase the unique character of the property. The minimalist Japanese-inspired landscape design creates a serene and peaceful environment while taking into account the Australian climatic conditions.

Upon entering the home, you are greeted with a

View : <https://www.mcewingpartners.com/lease/vic/bayside/mount-eliza/residential/house/7491837>



Samantha Stephenson
0397872422

38 Wimbledon Avenue, Mount Eliza

3 Bed 2 Bath 2 Car



FLOOR PLAN

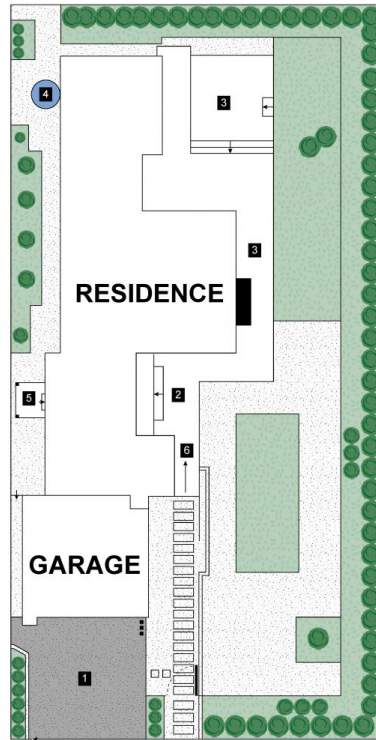

SITE PLAN

LEGEND

1. Driveway
2. Porch
3. Deck
4. Water Tank
5. Patio
6. Ramp

Internal : 223m²
External : 98m²

