



33 Rendlesham Avenue MOUNT ELIZA VIC

2 2 2

Laying claim to one of Mount Eliza's most coveted beachfront addresses, this unique and iconic beachfront residence positioned only paces from Ranelagh Beach combines mesmerising bay aspects with a unique design to beautifully embrace its privileged seaside position.

Pairing nautical influences with vaulted timber ceilings and light-filled interiors, the home ensures horizon views remain a hero of almost every room. Ample glazing dissolves indoor/outdoor boundaries across sun-drenched entertaining space, as refined lounge and dining zones converge across a well-equipped kitchen, complete with stone surfaces and stainless appliances.

Partially shaded by a magnificent pine, alfresco dining is made to feel at arms' reach from the shoreline before a serene terrace offers a private retreat. Orientated to wake

View : <https://www.mcewingpartners.com/sale/vic/bayside/mount-eliza/residential/house/7471726>



Quentin McEwing
0397872422



Kelsi Culhane
0397872422

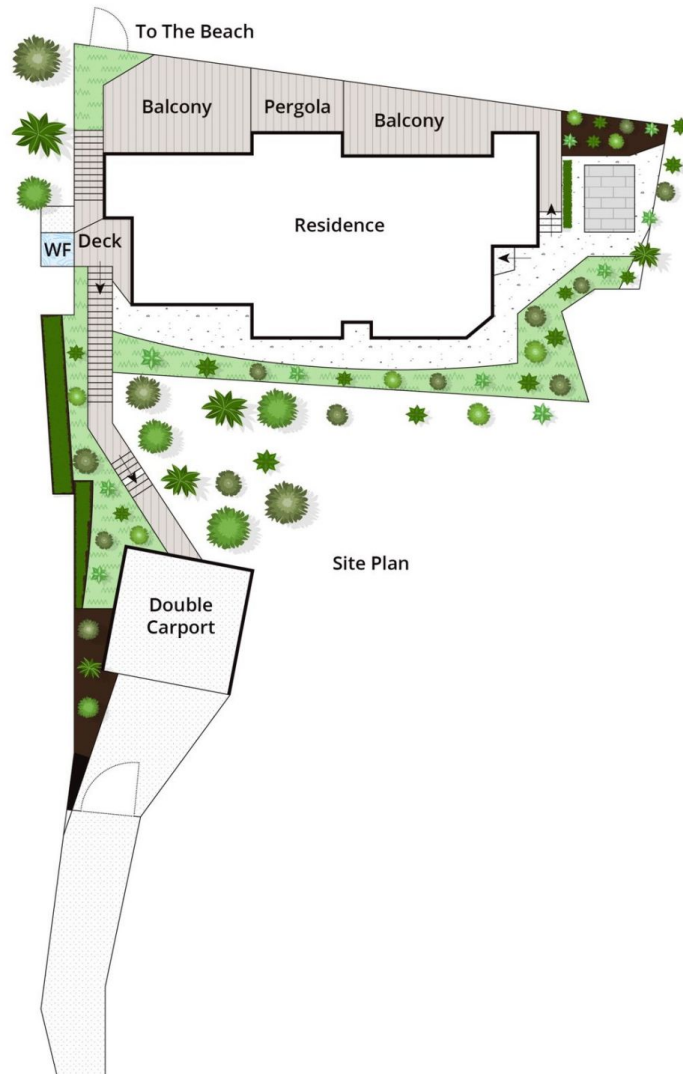
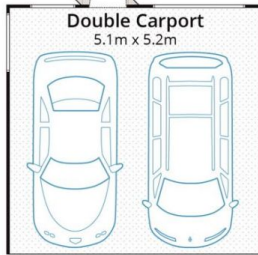
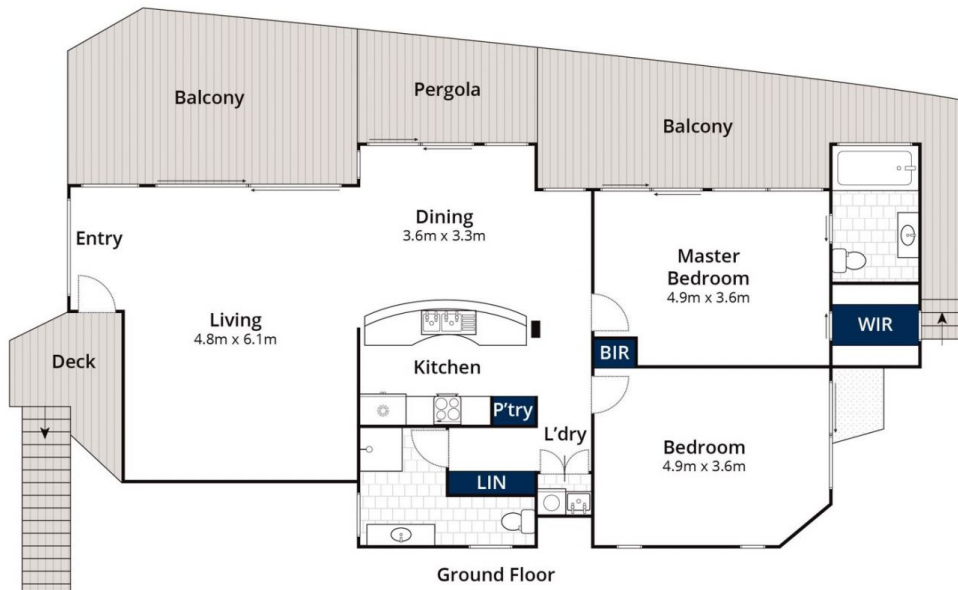

Approx House Area 118m²
Approx Land Area 467m²

Whilst bwr.com.au has made every attempt to ensure the accuracy of the floor plan contained here, measurements are approximate and no responsibility is taken for any error, omission, or mis-statement. This plan is for illustrative purposes only.

33 Rendlesham Avenue, Mount Eliza