

105 Rutland Avenue MOUNT ELIZA VIC

4 2 2

Defined by a sophisticated contemporary elegance and relaxed coastal ambience at one with this prized beachside locale, this sundrenched 4-bedroom home offers an enviable opportunity for families to upgrade into easy living just 500 metres to Mount Eliza village. Directly opposite leafy parkland and an easy walk to excellent schools and golden beaches, the striking entry hall sets a tranquil tone with walls of windows framing the leafy landscape beyond. High ceilings and polished timber floors amplify the space and light in the spacious central living zone, which flows out to a north-facing barbecue deck with large electric sun awning to host in the open air. Black granite countertops pair with sleek white cabinetry and Smeg stainless-steel appliances in the exquisite cook's kitchen, while the capacious fourth bedroom with walk-in storage off the entry would also make a superb home office or plush second lounge in this stunning seaside sanctuary in highly sought

View : <https://www.mcewingpartners.com/sale/vic/bayside/mount-eliza/residential/house/7457441>



Quentin McEwing
0397872422



Kelsi Culhane
0397872422

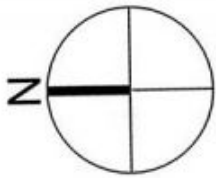

Internal Area = 20 squares (approx.)

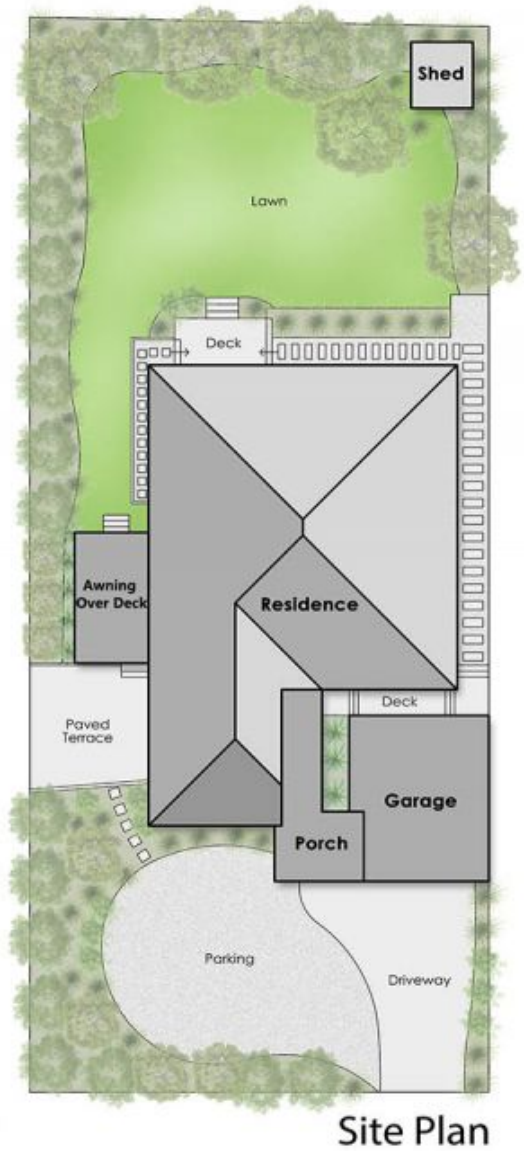

105 Rutland Avenue, Mount Eliza

This floorplan is for illustration purposes only and no warranty is given to its accuracy. Purchasers are advised to carry out their own investigations.