



24 Granya Grove MOUNT ELIZA VIC

5 🛏 3 🚿 2 🚗

Mastering a striking synergy between contemporary coastal luxe and timeless mid-century elegance paying homage to the original abode, this exquisitely reimagined and newly completed six-bedroom home by premium custom builders GSTRUCT GROUP captivates with its high-end finishes and resort-style integration of indoor and outdoor spaces. Footsteps from Ranelagh Beach, electronic gates glide open to reveal an elevated design crafted to capture panoramic bay views and a north-facing aspect, which is further amplified via a glass cathedral ceiling over the breathtaking primary living room. A retro-chic curved breakfast island anchors the epicurean kitchen fitted with a suite of integrated appliances and a butler's pantry, while a hideaway second lounge downstairs is ideal for the kids or cosy nights at home. Walls of vast sliding stacker doors

Type : House

View : <https://www.mcewingpartners.com/sale/vic/bayside/mount-eliza/residential/house/7418507>



Dean Phillips
0359754555



Kelsi Culhane
0397872422

[For full version visit the website](https://www.mcewingpartners.com)

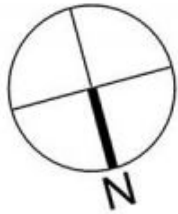

Internal Area = 30.5 squares (approx.)



Upper Floor

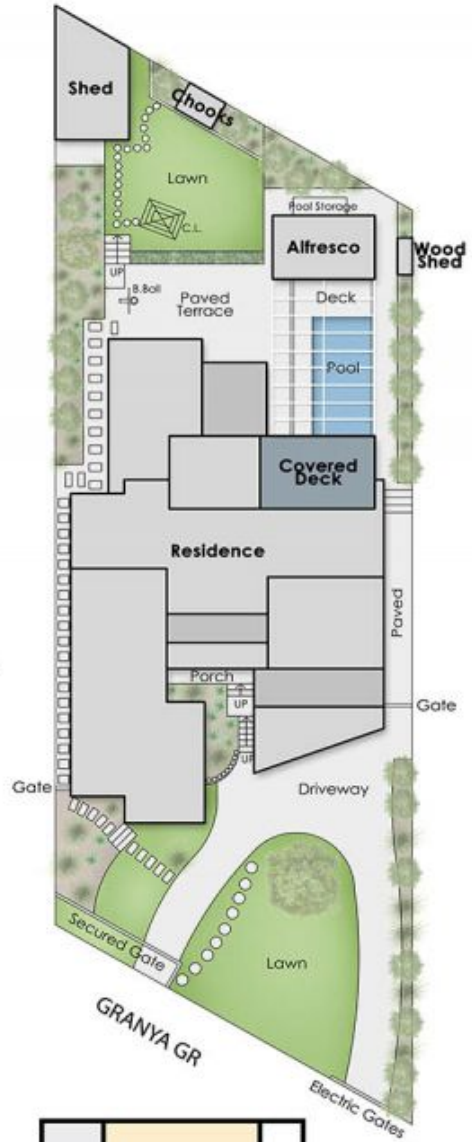

Lower Floor

24 Granya Grove, Mount Eliza

This floorplan is for illustration purposes only and no warranty is given to its accuracy. Purchasers are advised to carry out their own investigations.