



T01/217 Point Nepean Road DROMANA VIC

- Total size 260sqm (approx.)
- Absolute prime exposure position in the heart of Dromana
- Positioned directly opposite Pier on Nepean Highway
- Ample street parking to customers
- Prime retail position
- Large open space floorplan with 3 access points with adjoining breezeway

Type : Retail
Building Size : 260 sqm
View : <https://www.mcewingpartners.com/lease/vic/mornington-peninsula/dromana/commercial/retail/7292220>



Dean Phillips
0359754555



Samantha Stephenson
0397872422

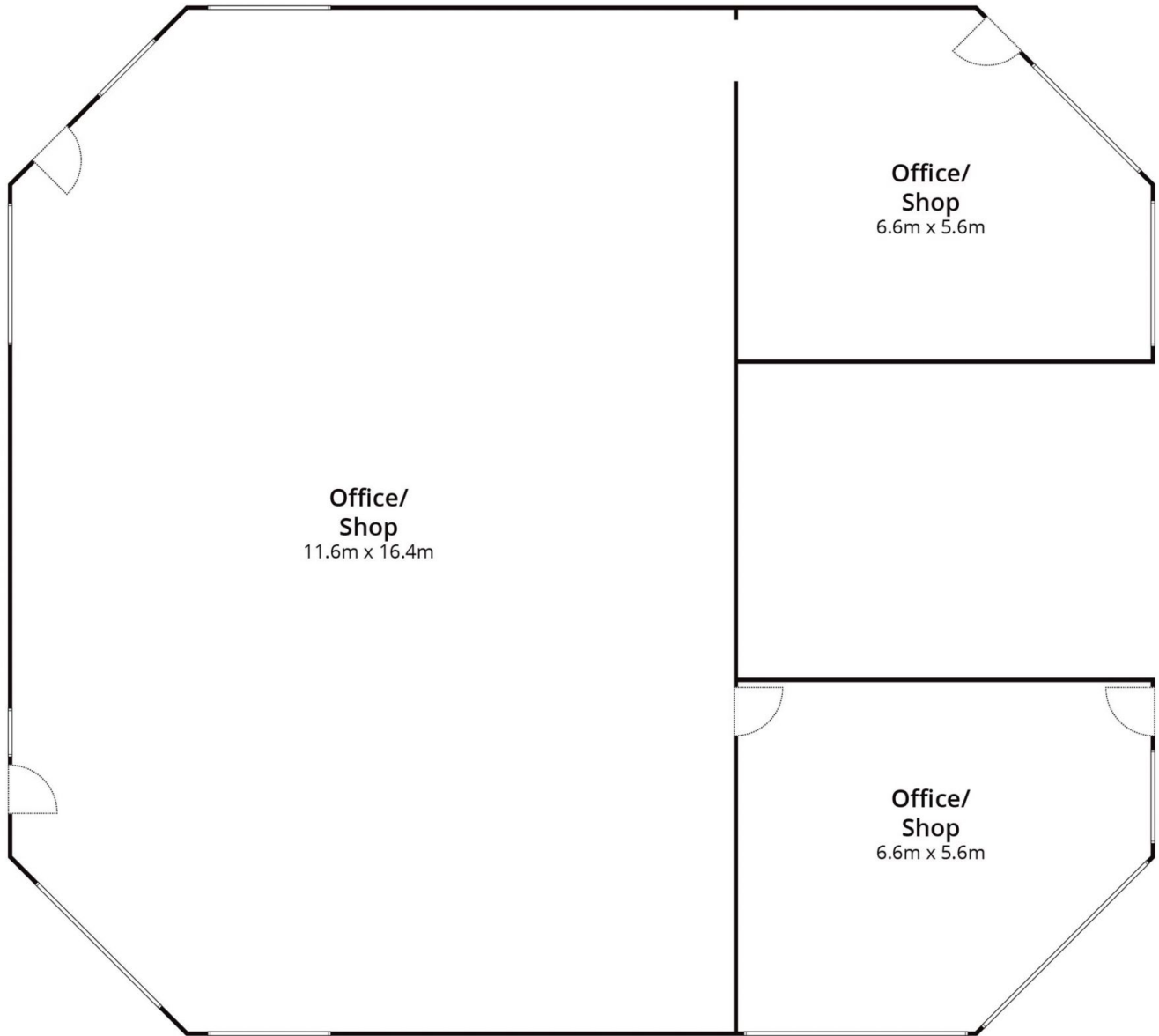

Approx. Shop Area 260m²

Whilst bwr.com.au has made every attempt to ensure the accuracy of the floor plan contained here, measurements are approximate and no responsibility is taken for any error, omission, or mis-statement. This plan is for illustrative purposes only.

Shop T01, Dromana Hub, 217 Point Nepean Road, Dromana